

LED FLOOD LIGHT HOT PRODUCT

明星产品 F1008



特性 Features



高效能LED晶粒
High Performance LED Chips



专业光学设计
Professional Optics Design



操作环境 -10°C~40°C
Operating Temperature -10°C~40°C



暖白光演色性 > 80
CRI > 80 in Warm White Series



产品保固5年
Warranty: Product 5 Years



绝佳的散热处理技术
Excellent Thermal Solution



内置LED定电流驱动
Build-in LED Driver



防护等级: IP65
Ingress Protection: IP65

亚运会场馆 The Asian Games stadium

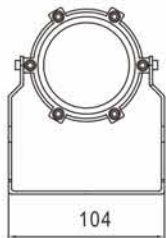
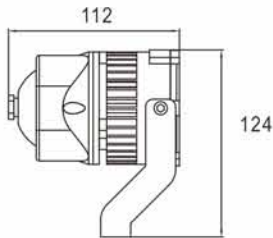

Unit:mm

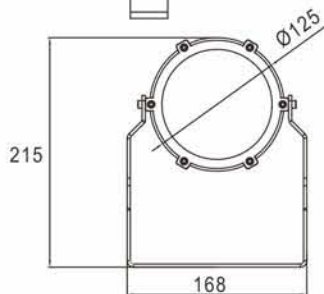
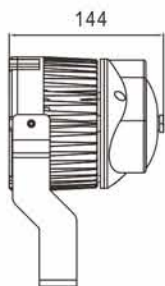

Unit:mm

F1003



| | | |
|-------|-----------------------|---------------------|
| LED颗数 | LED Q'ty | 3 |
| LED颜色 | LED Color | A, B, W, WA |
| 输入电压 | Input Current | 100~240VAC 50/60 Hz |
| 输出电流 | Output Current | 700mA±5% |
| LED功率 | LED Power Consumption | 7W |
| 流明值 | Lumen Output | > 360 lm |
| 光学角度 | Beam Angle | 10°, 20°, 30° |

F1003



| | | |
|-------|-----------------------|---------------|
| LED颗数 | LED Q'ty | 3 (1 Set RGB) |
| 输入电压 | Input Current | 24VDC |
| 输出电流 | Output Current | 350mA±5% |
| LED功率 | LED Power Consumption | max. 3.5W |
| 通讯协定 | Protocol | DMX-512 1900 |
| 光学角度 | Beam Angle | 10°, 20°, 30° |

F1005



| | | |
|-------|-----------------------|---------------------|
| LED颗数 | LED Q'ty | 9 |
| LED颜色 | LED Color | A, B, W, WA |
| 输入电压 | Input Current | 100~240VAC 50/60 Hz |
| 输出电流 | Output Current | 700mA±5% |
| LED功率 | LED Power Consumption | 21W |
| 流明值 | Lumen Output | > 1100 lm |
| 光学角度 | Beam Angle | 10°, 20°, 30° |

F1005



| | | |
|-------|-----------------------|----------------|
| LED颗数 | LED Q'ty | 9 (3 Sets RGB) |
| 输入电压 | Input Current | 24VDC |
| 输出电流 | Output Current | 350mA±5% |
| LED功率 | LED Power Consumption | max. 10W |
| 通讯协定 | Protocol | DMX-512 1900 |
| 光学角度 | Beam Angle | 10°, 20°, 30° |



F1008



| | | |
|-------|-----------------------|------------------------|
| LED颗数 | LED Q'ty | 16 |
| LED颜色 | LED Color | A, B, W, WA |
| 输入电压 | Input Current | 100~240VAC 50/60 Hz |
| 输出电流 | Output Current | 700mA±5% |
| 长度 | Length | 600mm |
| LED功率 | LED Power Consumption | 38W |
| 流明值 | Lumen Output | >2000 lm |
| 光学角度 | Beam Angle | 10°, 20°, 30°, 10°x35° |

F1008



| | | |
|-------|-----------------------|------------------------|
| LED颗数 | LED Q'ty | 18 (6 Sets RGB) |
| 输入电压 | Input Current | 24VDC |
| 输出电流 | Output Current | 350mA±5% |
| 长度 | Length | 600mm |
| LED功率 | LED Power Consumption | max. 19W |
| 通讯协定 | Protocol | DMX-512 1900 |
| 光学角度 | Beam Angle | 10°, 20°, 30°, 10°x35° |

F1008



| | | |
|-------|-----------------------|---------------------|
| LED颗数 | LED Q'ty | 32 |
| LED颜色 | LED Color | A, B, W, WA |
| 输入电压 | Input Current | 100~240VAC 50/60 Hz |
| 输出电流 | Output Current | 700mA±5% |
| 长度 | Length | 1200mm |
| LED功率 | LED Power Consumption | 76W |
| 流明值 | Lumen Output | >4000 lm |

F1008



| | | |
|-------|-----------------------|------------------------|
| LED颗数 | LED Q'ty | 36 (12 Sets RGB) |
| 输入电压 | Input Current | 24VDC |
| 输出电流 | Output Current | 350mA±5% |
| 长度 | Length | 1200mm |
| LED功率 | LED Power Consumption | max. 38W |
| 通讯协定 | Protocol | DMX-512 1900 |
| 光学角度 | Beam Angle | 10°, 25°, 45°, 10°x35° |



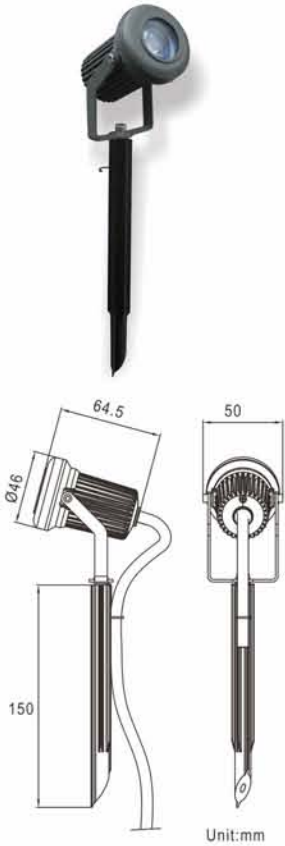

F1012



| | | |
|-------|-----------------------|-------------|
| LED颗数 | LED Q'ty | 1 |
| LED颜色 | LED Color | A, B, W, WA |
| 输入电压 | Input Current | 12VDC |
| 输出电流 | Output Current | 350mA±5% |
| LED功率 | LED Power Consumption | 3.5W |
| 流明值 | Lumen Output | > 180 lm |

F1012



| | | |
|-------|-----------------------|----------------|
| LED颗数 | LED Q'ty | 1 (1 Sets RGB) |
| 输入电压 | Input Current | 12VDC |
| 输出电流 | Output Current | 350mA±5% |
| LED功率 | LED Power Consumption | max. 3.5W |
| 通讯协定 | Protocol | DMX-512 1900 |
| 光学角度 | Beam Angle | 15°, 45° |

F1014



| | | |
|-------|-----------------------|---------------------|
| LED颗数 | LED Q'ty | 18 |
| LED颜色 | LED Color | A, B, W, WA |
| 输入电压 | Input Current | 100~240VAC 50/60 Hz |
| 输出电流 | Output Current | 700mA±5% |
| LED功率 | LED Power Consumption | 45W |
| 流明值 | Lumen Output | > 2200 lm |

F1014



| | | |
|-------|-----------------------|---------------------|
| LED颗数 | LED Q'ty | 18 (6 Sets RGB) |
| 输入电压 | Input Current | 100~240VAC 50/60 Hz |
| 输出电流 | Output Current | 350mA±5% |
| LED功率 | LED Power Consumption | max. 24W |
| 通讯协定 | Protocol | DMX-512 1900 |
| 光学角度 | Beam Angle | 10°, 20°, 30° |



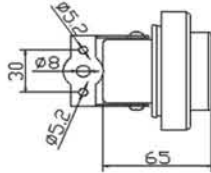
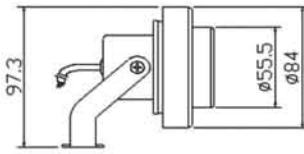

Unit:mm

F1113



| | | |
|-------|-----------------------|-------------|
| LED颗数 | LED Q'ty | 3 |
| LED颜色 | LED Color | A, B, W, WA |
| 输入电压 | Input Current | 24VDC |
| 输出电流 | Output Current | 350mA±5% |
| LED功率 | LED Power Consumption | 3.5W |
| 流明值 | Lumen Output | > 180 lm |

F1113



| | | |
|-------|-----------------------|----------------|
| LED颗数 | LED Q'ty | 3 (1 Sets RGB) |
| 输入电压 | Input Current | 24VDC |
| 输出电流 | Output Current | 350mA±5% |
| LED功率 | LED Power Consumption | max. 3.5W |
| 通讯协定 | Protocol | DMX-512 1900 |
| 光学角度 | Beam Angle | 10°, 25°, 45° |

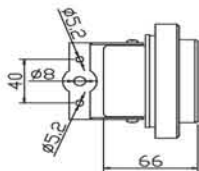
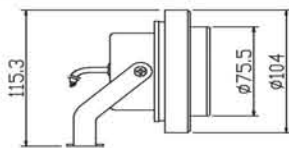

Unit:mm

F1114



| | | |
|-------|-----------------------|-------------|
| LED颗数 | LED Q'ty | 6 |
| LED颜色 | LED Color | A, B, W, WA |
| 输入电压 | Input Current | 24VDC |
| 输出电流 | Output Current | 350mA±5% |
| LED功率 | LED Power Consumption | 7.5W |
| 流明值 | Lumen Output | > 350 lm |

F1114



| | | |
|-------|-----------------------|----------------|
| LED颗数 | LED Q'ty | 6 (2 Sets RGB) |
| 输入电压 | Input Current | 24VDC |
| 输出电流 | Output Current | 350mA±5% |
| LED功率 | LED Power Consumption | max. 7.5W |
| 通讯协定 | Protocol | DMX-512 1900 |
| 光学角度 | Beam Angle | 10°, 25°, 45° |